

July 1, 1996
ddes/jk

ROB MCKENNA
Introduced by: Louise Miller
Proposed No.: 96-606

ORDINANCE NO. 12442

AN ORDINANCE related to road redesignation;
changing the name of Northeast 102nd Place,
Northeast 108th Place, 200th Avenue Northeast,
and Northeast 113th Place to "Northeast Redmond
Road."

PREAMBLE:

Portions of the stretch of roadway commonly known as
"Redmond Road" have four different official designa-
tions, but the street signs and addresses have never
been properly changed to reflect these designations.
There are now two different addressing schemes in use,
causing confusion and difficulty for emergency vehicles
attempting to locate homes in emergency situations.
Additionally, the postal service has encountered
delivery problems due to the current addressing schemes.

BE IT ORDAINED BY THE COUNCIL OF KING COUNTY:

SECTION 1. The continuous stretch of roadway commonly
known as "Redmond Road," designated as Northeast 102nd Place,
Northeast 108th Place, 200th Avenue Northeast, and Northeast
113th Place, described as commencing in a northeasterly
direction from Novelty Hill Road in Section 31, Township 26
North, Range 6 East and ending thirty feet west of the north-
south centerline of Section 32, Township 26 North, Range 6
East, and described on Attachment A and shown on Attachment B
to this ordinance, is hereby redesignated in its entirety as
"Northeast Redmond Road."

SECTION 2. The 20-day notice requirement for affected
property owners in Ordinance 10915, Section 2 shall be met.

SECTION 3. The director of the department of public works
shall accomplish any necessary sign changes within sixty days
of the effective date of this ordinance.

1
2
3
4
5
6
7
8
9
10
11
12
13
14
15
16
17
18
19
20
21
22
23
24
25
26
27
28
29
30
31
32
33
34
35
36
37
38
39
40
41
42
43
44
45
46
47
48
49

SECTION 4. The director of the department of development and environmental services shall accomplish any necessary address correction notifications within ninety days of the effective date of this ordinance.

INTRODUCED AND READ for the first time this 22nd day of July, 1996.

PASSED by a vote of 12 to 0 this 3rd day of September, 1996.

KING COUNTY COUNCIL
KING COUNTY, WASHINGTON

Chair

ATTEST:

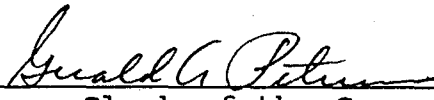
Clerk of the Council

APPROVED this 13th day of September, 1996

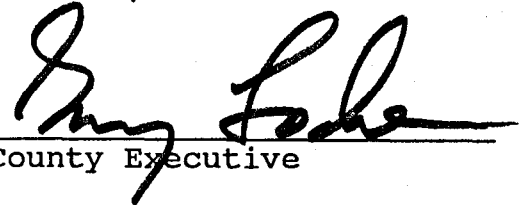
King County Executive

- Attachments:
A. Description
B. Map

**ATTACHMENT A
NORTHEAST REDMOND ROAD
ABBREVIATED LEGAL DESCRIPTION**

The following described portions of roadways are hereby redesignated as "Northeast Redmond Road".

Section 31, Township 26 North, Range 6 East W.M.

Northeast 102nd Place, lying north of King County short plat #379175, and lying north of that portion of the east 60 feet of the SW quarter of the SE quarter lying southerly of co rd, and lying north of lots 42 - 44 in block 80 of Burke & Farrar's Kirkland Addition #24.

Northeast 108th Place, lying southeasterly of Farrel-McWhirter Park and the Redmond city limits, in the southeast corner of the NE quarter of the SE quarter.

Section 32, Township 26 North, Range 6 East W.M.

Northeast 108th Place, lying south and east of lots 7 - 11 in block 74 of Burke & Farrar's Kirkland Addition #24.

200th Avenue Northeast, lying east of lots 12 - 13 in block 74 of Burke & Farrar's Kirkland Addition #24.

Northeast 113th Place, lying north of lots 21 - 23 in block 76 of Burke & Farrar's Kirkland Addition #24.

12442

ATTACHMENT B
NE REDMOND ROAD

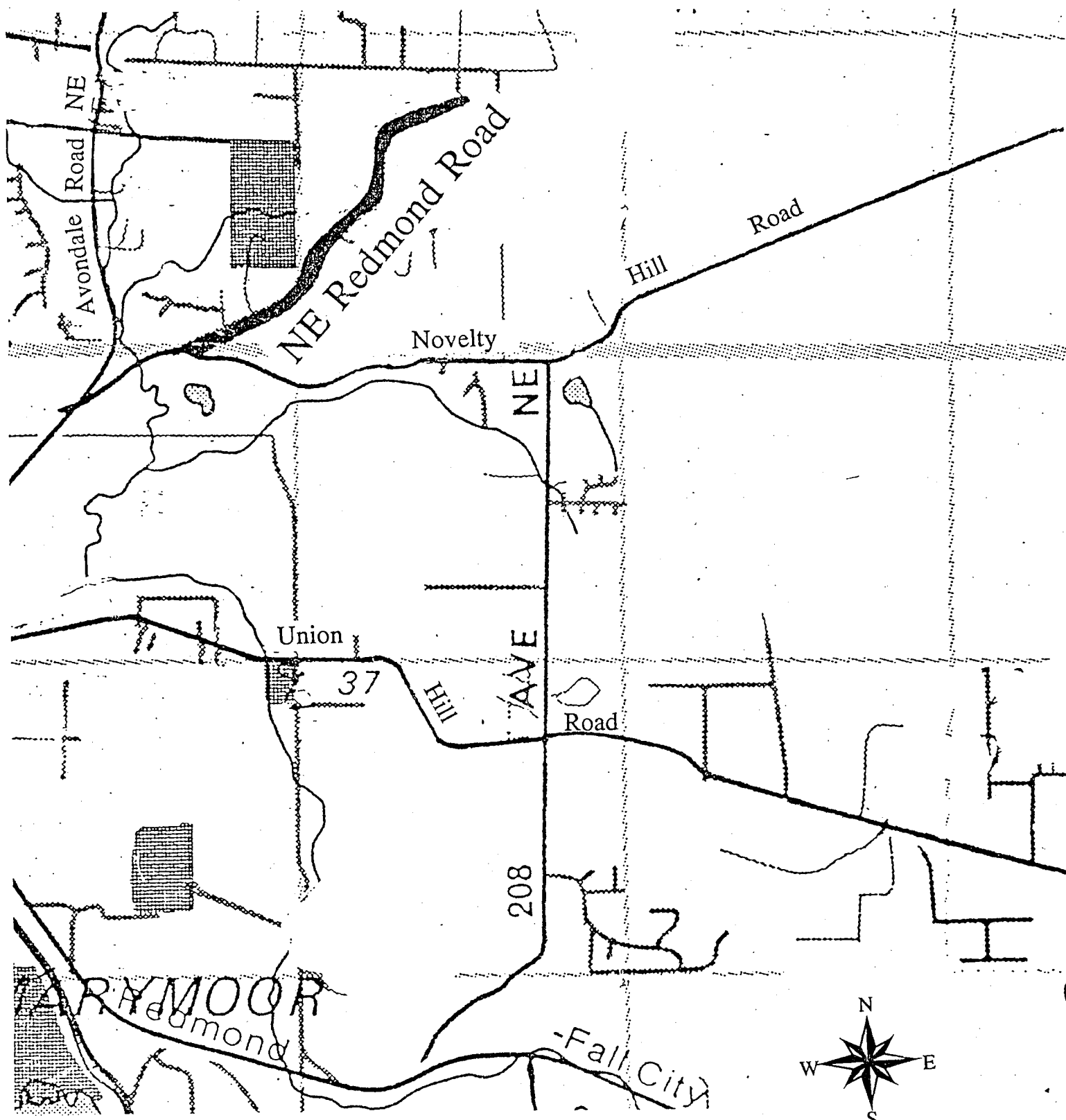

12442

ATTACHMENT B
NE REDMOND ROAD

